



Nick M. Gombash ▶ **Descendants of the Jersey Settlers
of Adams County, Mississippi**

June 11, 2015 · 🌐

Hi everyone! I found this plat that was created in September 1821 for the probate estate of Gideon Hopkins (son of David & Bethia Hopkins) who was married to Sarah "Sally" Luse (daughter of Israel Luse and Deborah Swayze). Gideon and Sarah are my 5xg-grandparents. You'll see that the estate was divided up amongst their 8 children, listed as follows:

Lot No 1. containg. 81 50/100 Acres to Prudence Hopkins

Lot No 2. containg. 81 50/100 Acres to Mary Hopkins

Lot No 3. containg. 25 71/100 Acres to Gideon Hopkins

Lot No 4. containg. 29 Acres to Berthia Costilow

Lot No 5. containg. 30 Acres to Charlotte Hopkins

Lot No 6. containg. 30 Acres to Deborah Chambers

Lot No 7. containg. 26 Acres to Lydia Hopkins

Lot No 8. containg. 25 50/100 Acres to Rachel Hopkins

I descend through their daughter Bethia (Berthia) who married James Costilow in 1818.

Heirs of Joseph King.

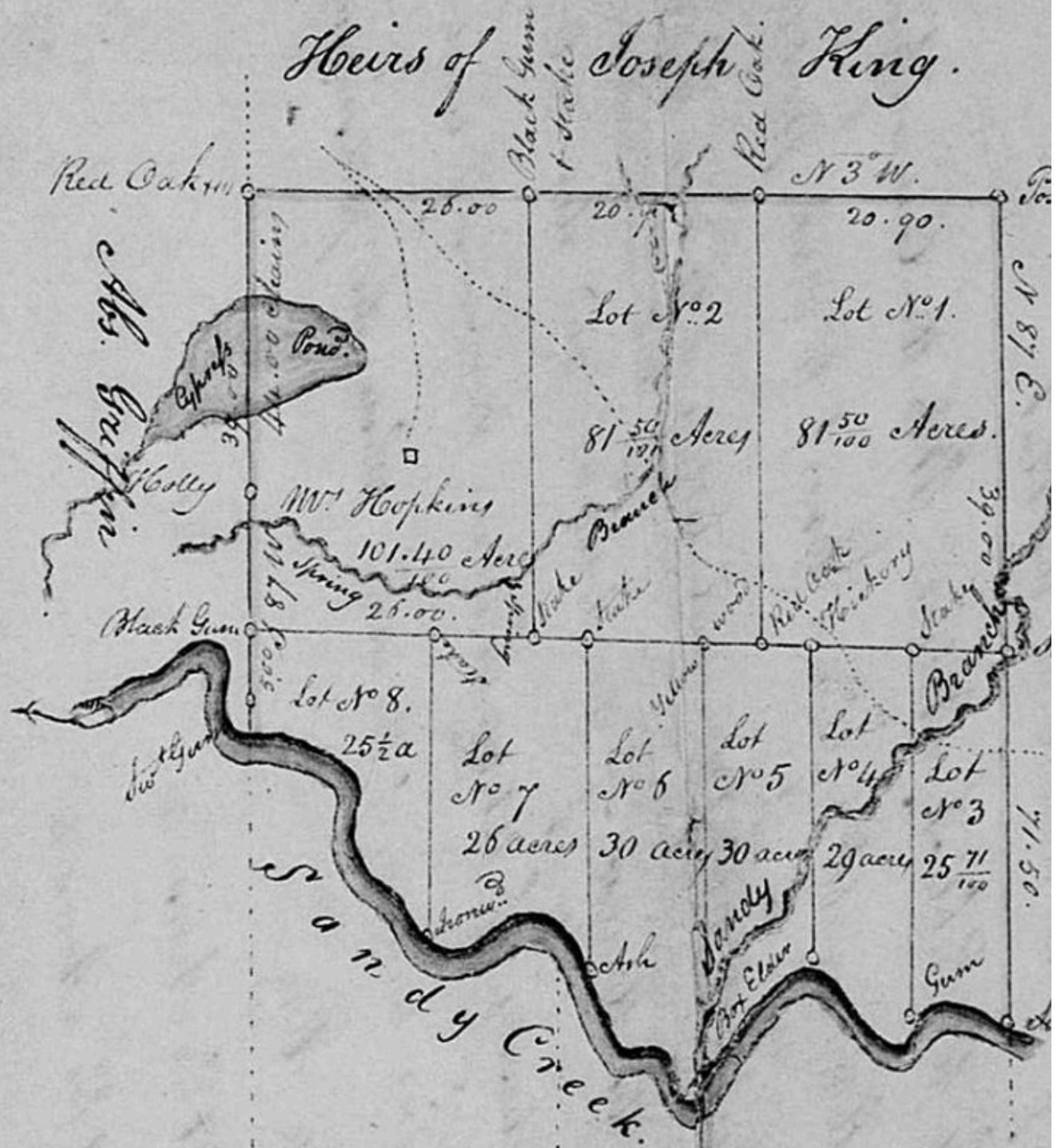

Estate of Gabriel Swayze deceased.